

LIVERMORES

THE ESTATE AGENTS

1 Bedrooms

House - End Terrace

Price Guide

£265,000

Located in

Dartford



www.livermores.co.uk



45 Eton Way

Dartford DA1 5HL



GUIDE PRICE £265,000 - £275,000... Livermore's are proud to present this super one double bedroom end house situated in a quiet close that will appeal to a first time buyer, a person wishing to downsize or a buy to let investor. This well kept home benefits from gas central heating and double glazing. It is further complimented by a fitted kitchen, white bathroom suite, allocated parking and own good sized garden. Conveniently located for Dartford and Crayford town centre plus the M25 and Dartford river crossing is nearby. **VIEWING RECOMMENDED**

45 Eton Way

£265,000 Freehold



- GUIDE PRICE £265,000 - £275,000
- GAS CENTRAL HEATING & DOUBLE GLAZING
- WHITE BATHROOM SUITE
- ALLOCATED PARKING
- COUNCIL TAX BAND C , EPC D
- 1 DOUBLE BEDROOM
- FITTED KITCHEN
- GOOD SIZED GARDEN
- CLOSE TO DARTFORD STATION
- SIMILAR PROPERTIES REQUIRED

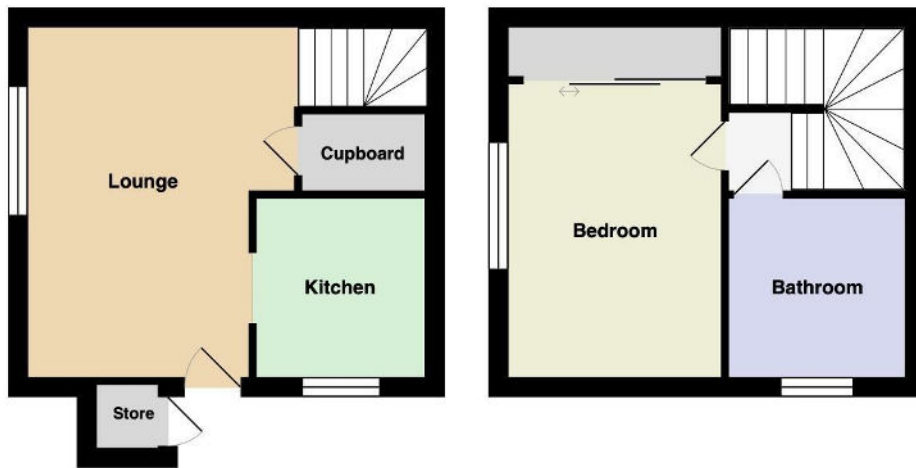

Council Tax Band C

Local Authority DARTFORD

Agents Note: Whilst every care has been taken to prepare these particulars, they are for guidance purposes only. All measurements are approximate and are for general guidance purposes only and whilst every care has been taken to ensure their accuracy, they should not be relied upon and potential buyers/tenants are advised to recheck the measurements.

Energy Efficiency Rating		Current	Maximum
Very energy efficient - lowest running costs			
(92 plus) A			90
(81-91) B			
(69-80) C		66	
(55-68) D			
(39-54) E			
(21-38) F			
(1-20) G			
Not energy efficient - higher running costs			
England & Wales		EU Directive 2002/91/EC	

1 Hythe Street
 Dartford
 Kent
 DA1 1BE



dartford@livermores.co.uk
 01322 228090
 www.company.co.uk