

LIVERMORES

THE ESTATE AGENTS

3 Bedrooms

House - Terraced

Offers In The Region Of

£375,000

Located in

Dartford



www.livermores.co.uk



36 Anne Of Cleves Road

Dartford Kent DA1 2BG

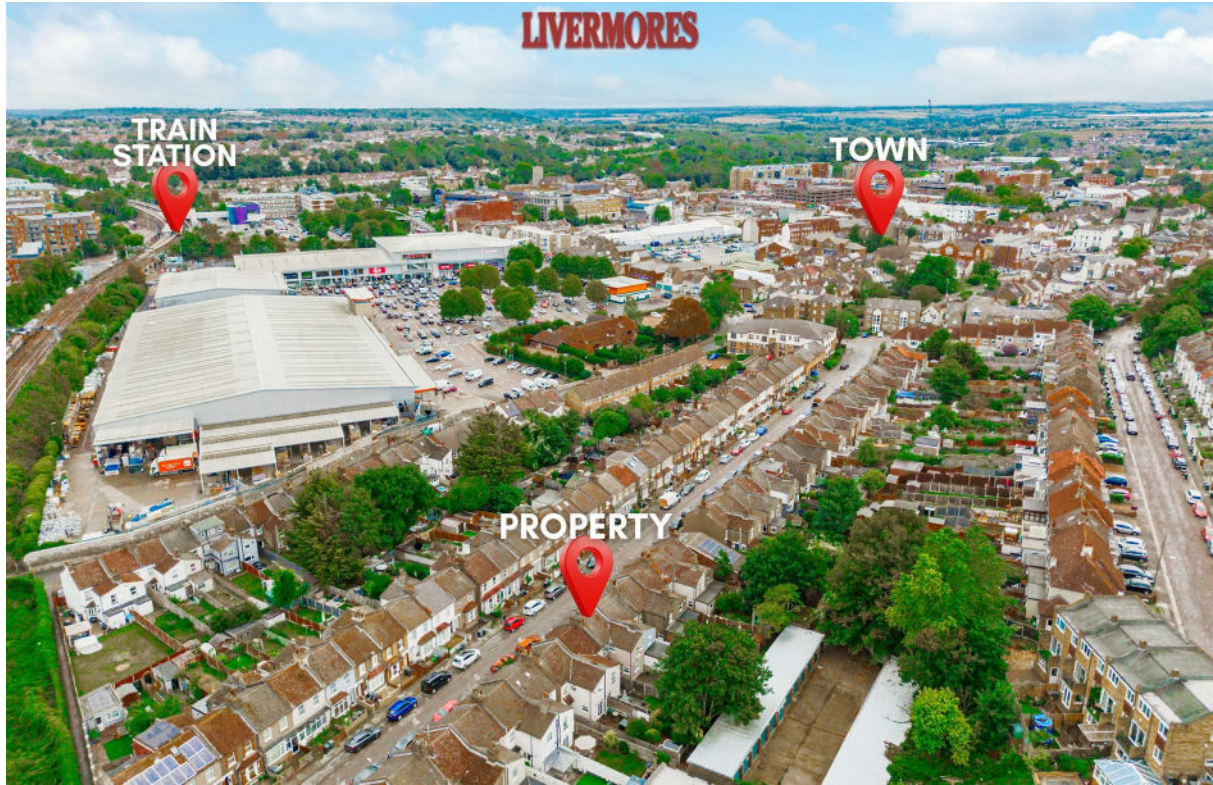

O.I.R.O £375,000 This excellent three-bedroom mid-terrace house presents an excellent opportunity for both families and investors alike. With NO ONWARD CHAIN, this property is located in the heart of DARTFORD TOWN CENTRE, the house boasts two spacious reception rooms, and fitted kitchen to the ground floor. One of the standout features of this property is its prime location, situated approximately two-thirds of a mile from the esteemed DARTFORD GRAMMAR SCHOOLS with Dartford Station approximately half a mile away, offering excellent transport links. To the first floor there are 3 bedrooms, bathroom and separate cloakroom. VIEWING HIGHLY RECOMMENDED.

36 Anne Of Cleves Road

£375,000 Freehold



- O.I.R.O £375,000
- DARTFORD GRAMMAR CATCHMENT
- 2 RECEPTION ROOMS
- 0.5 MILES TO DARTFORD STATION
- VIEWING RECOMMENDED
- NO ONWARD CHAIN
- 3 BEDROOMS
- FIRST FLOOR BATHROOM
- TOWN CENTRE LOCATION
- EPC RATING D COUNCIL TAX BAND C

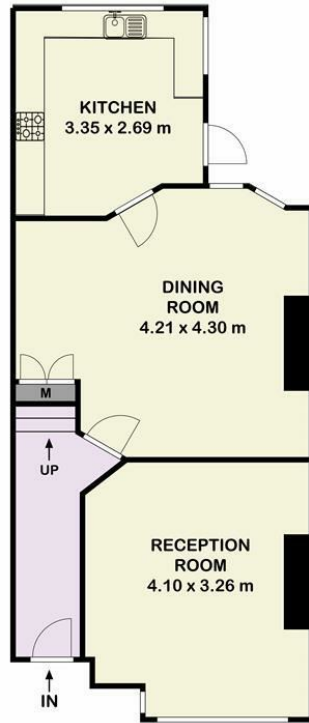

Ground Floor

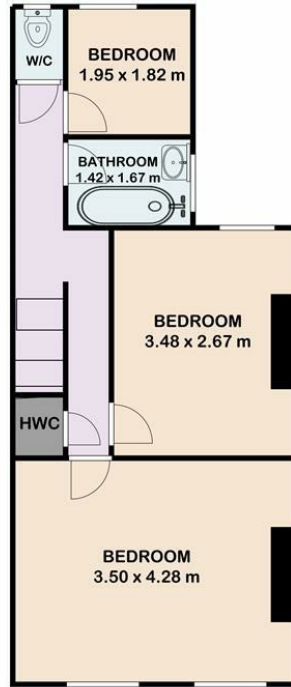

First Floor

Anne of Cleves Road Dartford Kent DA1 2BG

The plan is intended solely as a layout guide, and no liability is assumed for any errors, omissions, or inaccuracies. It does not constitute, in whole or in part, an offer or contract. Any intending purchaser or lessee should satisfy themselves, through inspection searches, enquiries, and a full survey, as to the accuracy of the information provided. All areas, measurements, shapes, compass bearing and distances are approximate and should not be relied upon for valuation purposes or as the basis of any sale or letting. No guarantee is provided regarding the total area, which may include areas with restricted head height. All measurements are taken at the widest points, internally, unless otherwise stated. May not be to scale. www.airvideography.com

Council Tax Band C

Local Authority Dartford

Agents Note: Whilst every care has been taken to prepare these particulars, they are for guidance purposes only. All measurements are approximate and are for general guidance purposes only and whilst every care has been taken to ensure their accuracy, they should not be relied upon and potential buyers/tenants are advised to recheck the measurements.

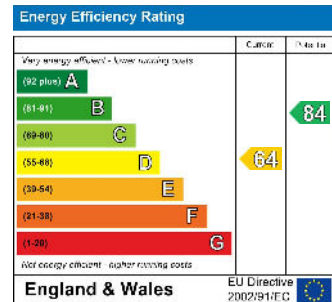

1 Hythe Street
 Dartford
 Kent
 DA1 1BE



dartford@livermores.co.uk
 01322 228090
 www.company.co.uk