

# LIVERMORES

THE ESTATE AGENTS

3 Bedrooms

House - Terraced

Price Guide

£450,000

Located in

Dartford



[www.livermores.co.uk](http://www.livermores.co.uk)



# 12 Waid Close

Dartford Kent DA1 1UL



Situated in a cul-de-sac this spacious mid terrace townhouse measuring just over 1300 square metres is ideally located just over HALF A MILE TO DARTFORD TRAIN STATION. Offered to the market in excellent condition the property comprises good size reception room with bi-fold doors out to the garden, lovely fitted kitchen, with ample Quartz worktops, 2 integrated fridges and a pull out larder cupboard, to the ground floor with 2 DOUBLE BEDROOMS and family bathroom to the first floor. The top floor has been extended and provides a huge bedroom with ensuite shower room, this could easily be converted to create two bedrooms giving this large family home 4 double rooms. Perfectly situated for the Leigh Academy Infant School the property also has a rear garden an drive way to the front. INTERNAL VIEWING HIGHLY RECOMMENDED.

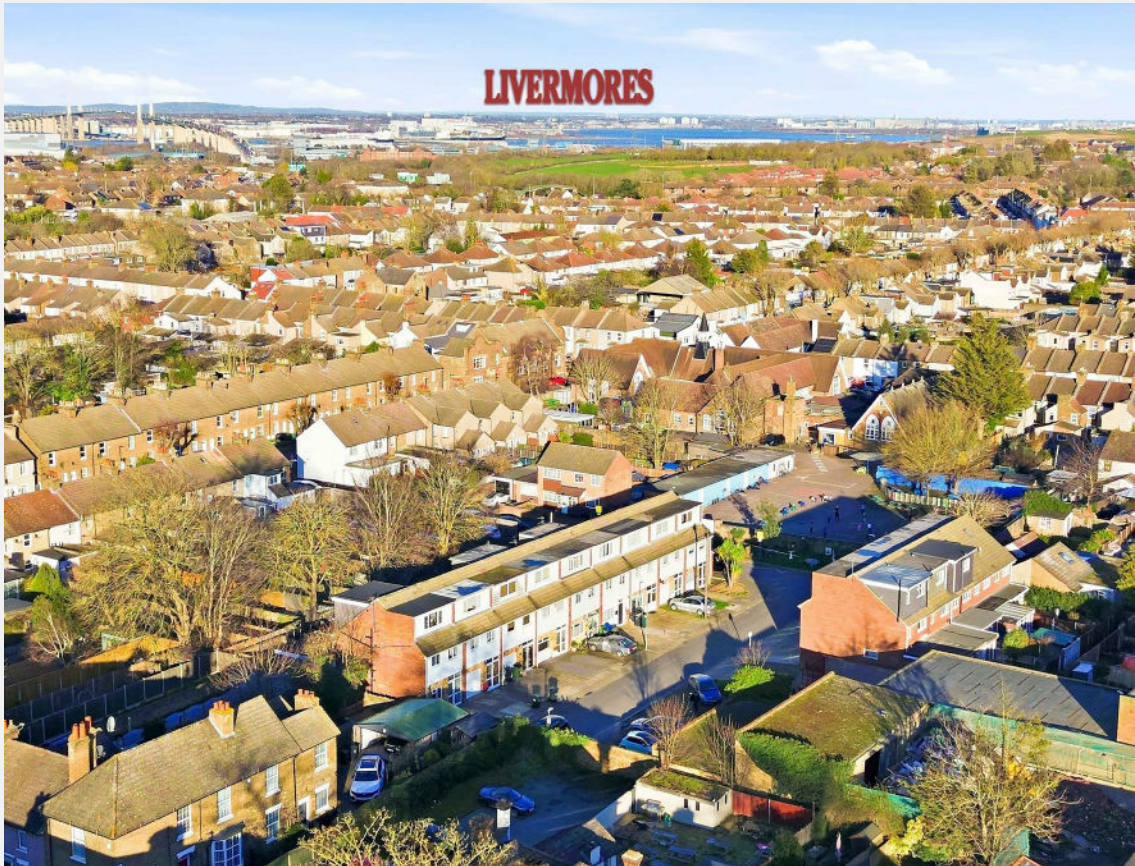

# 12 Waid Close

£450,000 Freehold



- SHORT WALK TO TOWN CENTRE
- LARGE RECEPTION ROOM
- 1ST FLOOR FAMILY BATHROOM
- CUL-DE-SAC LOCATION
- 0.6 MILES TO DARTFORD STATION
- 3 GOOD SIZE DOUBLE BEDROOMS
- LOVELY FITTED KITCHEN
- ENSUITE TO MASTER BEDROOM
- OFF ROAD PARKING
- EPC RATING C COUNCIL TAX BAND C





Outbuildings



Ground Floor

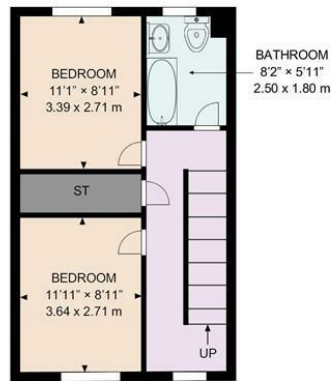

First Floor



Second Floor

WAID CLOSE, DA1

The plan is intended solely as a layout guide, and no liability is assumed for any errors, omissions, or inaccuracies. It does not constitute, in whole or in part, an offer or contract. Any intending purchaser or lessee should satisfy themselves, through inspection searches, enquiries, and a full survey, as to the accuracy of the information provided. All areas, measurements, wall thicknesses, shapes, compass bearing, and distances are approximate and should not be relied upon for valuation purposes or as the basis of any sale or letting. No guarantee is provided regarding the total area. All measurements are taken at the widest points, internally, with the first measurement referring to the vertical dimension. May not be to scale. Powered by airvideography.com

## Council Tax Band C

### Local Authority Dartford

Agents Note: Whilst every care has been taken to prepare these particulars, they are for guidance purposes only. All measurements are approximate and are for general guidance purposes only and whilst every care has been taken to ensure their accuracy, they should not be relied upon and potential buyers/tenants are advised to recheck the measurements.

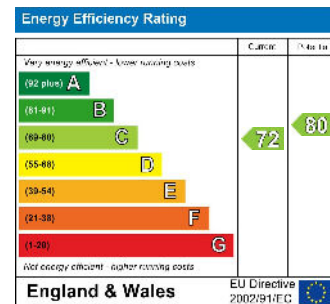

1 Hythe Street

Dartford

Kent

DA1 1BE

**LIVERMORES**  
THE ESTATE AGENTS

dartford@livermores.co.uk

01322 228090

www.livermores.co.uk